

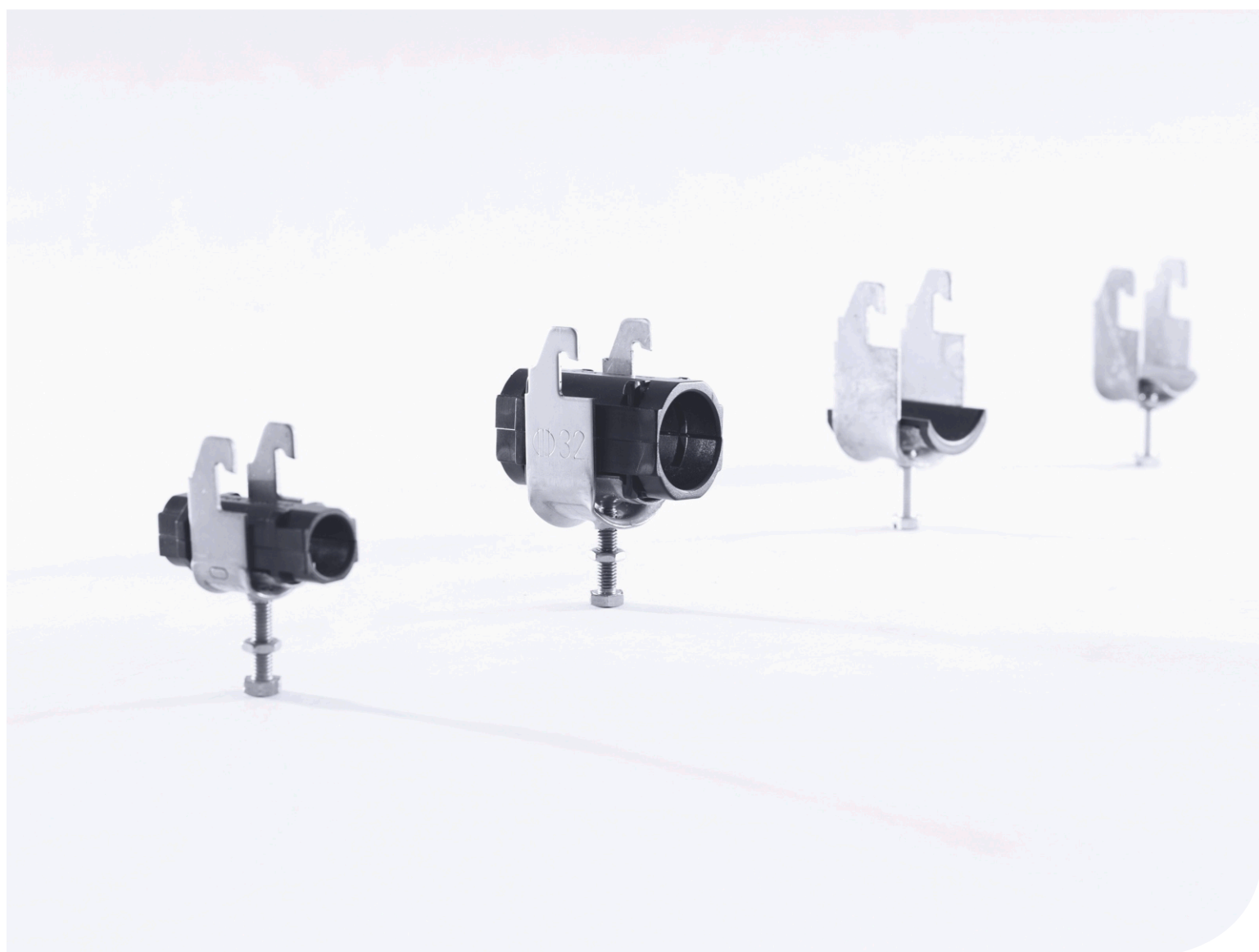

Uchwyty kablowe - zastosowanie

Informacja techniczna



EL-PUK Sp. z o.o.

Siedziba główna i zakład produkcyjny Konstantynów Łódzki

ul. Innowacyjna 4

95-050 Konstantynów Łódzki

Polska

Telefon: +48 42 211 88 01 Sekretariat

+48 42 211 88 10 Dział Sprzedaży

+48 42 211 88 25 Dział Ofert

+48 42 211 88 26 Dział Budów

+48 42 211 88 18 Dział Konstrukcyjny

+48 42 211 88 27 Dział Marketingu

elpuk@elpuk.com.pl

Magazyn Katowice

al. Roździeńskiego 188

40-203 Katowice

Polska

Telefon: +48 691 111 585

+48 693 330 669

katowice@elpuk.com

marketing@elpuk.com

www.elpuk.com.pl

Uchwyty kablowe

Uchwyty kablowe - zastosowanie [A05-A14](#)





Uchwyty kablowe - zastosowanie

Informacje techniczne

AC Montaż uchwyty AC

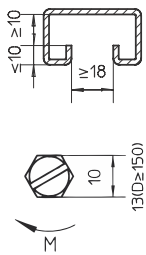
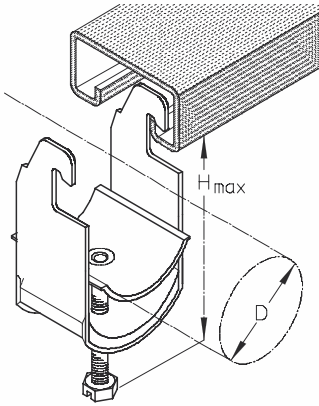

A 41 / KHA 41

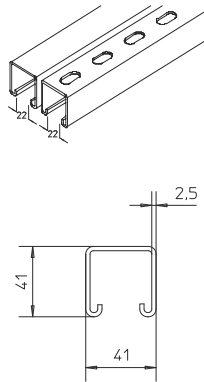

A 2 / KHA 2

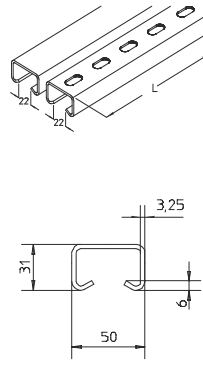

A 4 / KHA 4

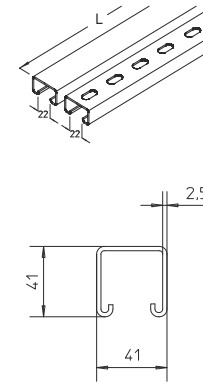

A 9 / KHA 9

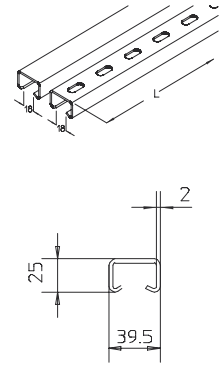

A 8 / KHA 8

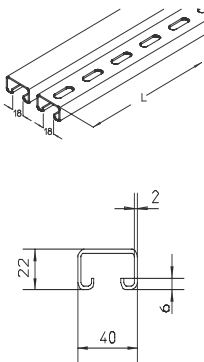

A 7 / KHA 7

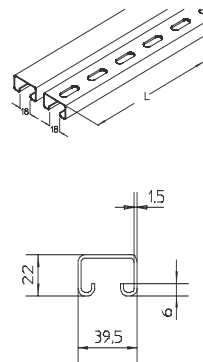

U-03 / UL-03

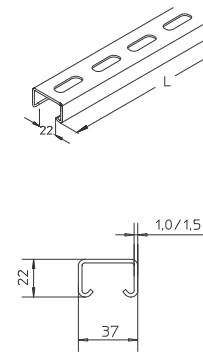

U-13 / UL-13

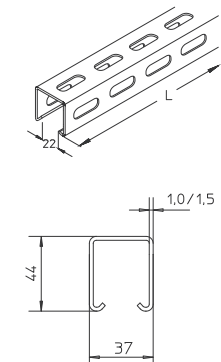

G 50

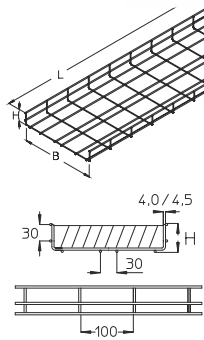

G 100

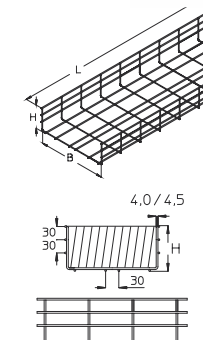

GI

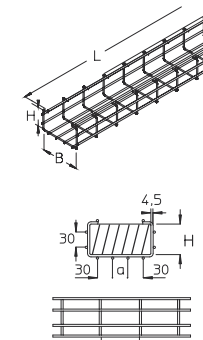

STU 50

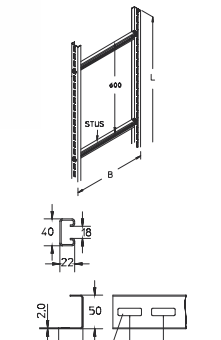

STU 60

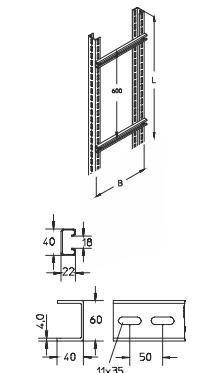

STU 62

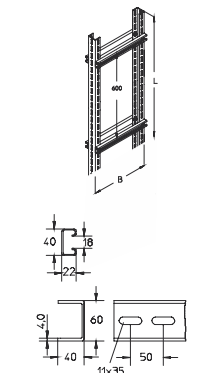

STU 81

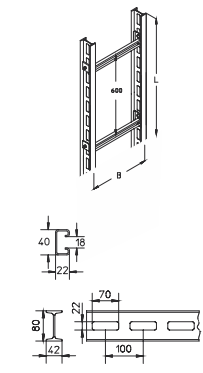

STU 82

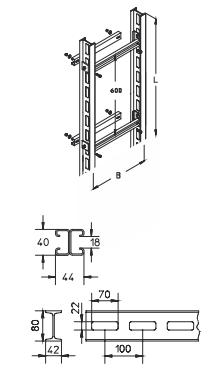

Uchwyty kablowe - zastosowanie

Informacje techniczne

AC-IW Montaż uchwyty AC-IW

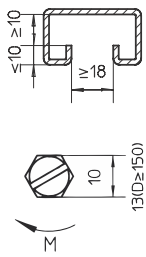
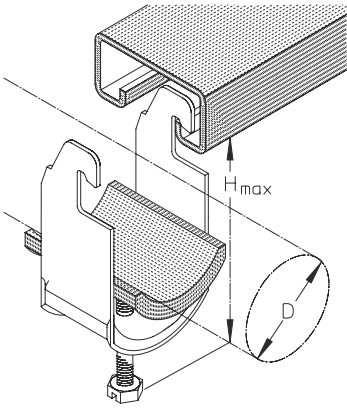

A 41 / KHA 41

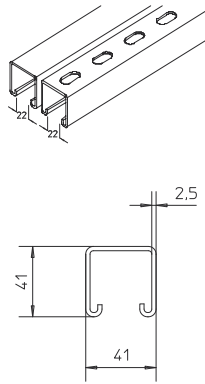

A 2 / KHA 2

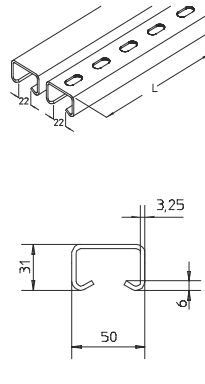

A 4 / KHA 4

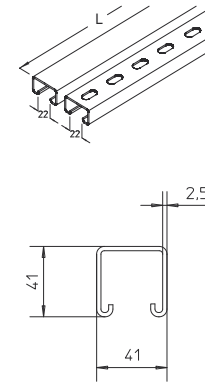

A 9 / KHA 9

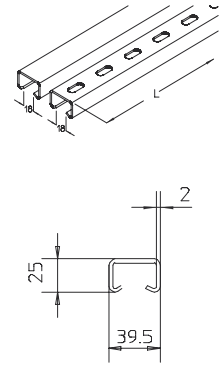

A 8 / KHA 8

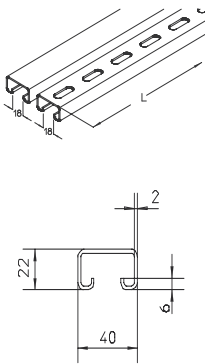

A 7 / KHA 7

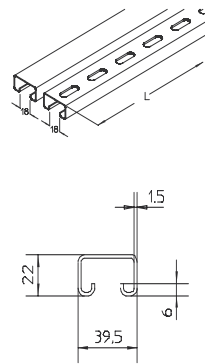

U-03 / UL-03

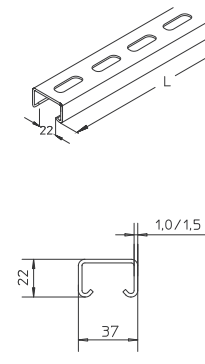

U-13 / UL-13

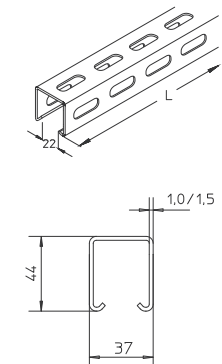

G 50

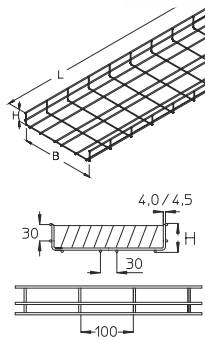

G 100

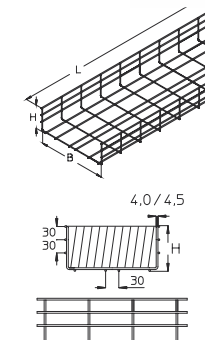

GI

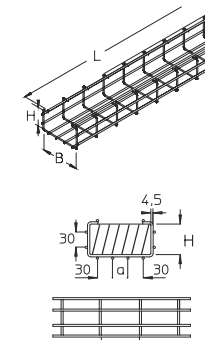

STU 50

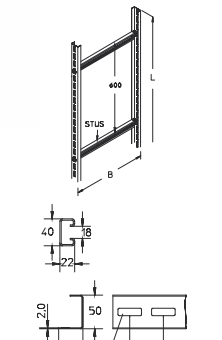

STU 60

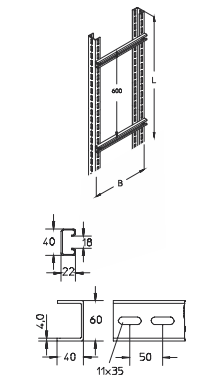

STU 62

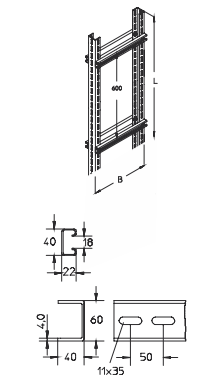

STU 81

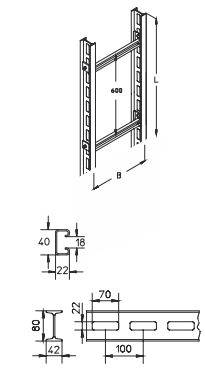

STU 82

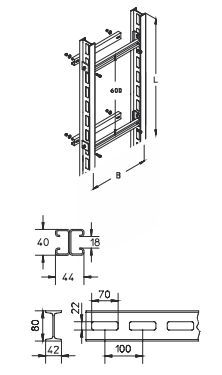

Uchwyty kablowe - zastosowanie

Informacje techniczne

H Montaż uchwyty H

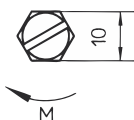
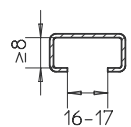
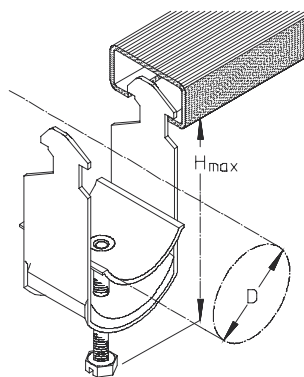

B 7 / KHB 7

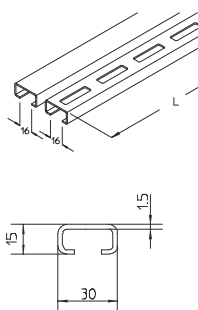

LGG 60

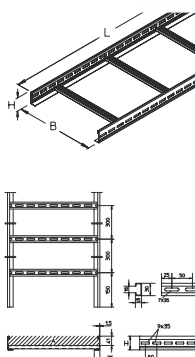

LGGS 60

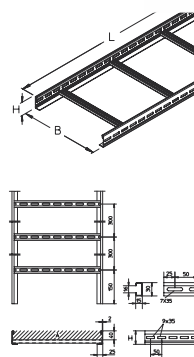

LGG 100

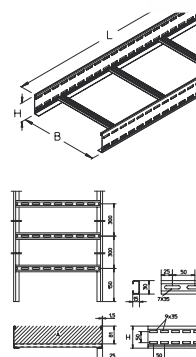

LGGS 100

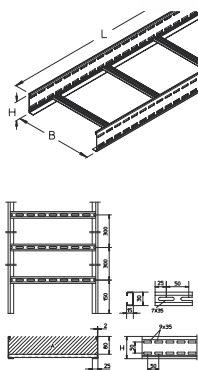

WPL 120

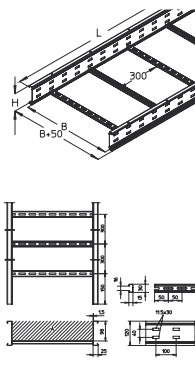

WPL 150

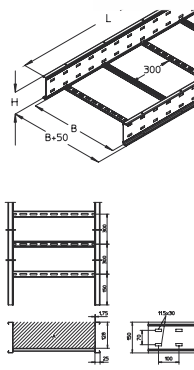

Uchwyty kablowe - zastosowanie

Informacje techniczne

H-IW Montaż uchwyty H-IW

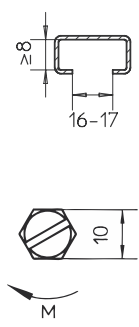
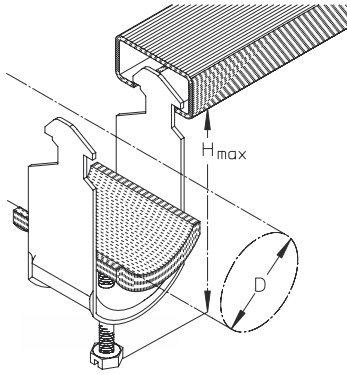

B 7 / KHB 7

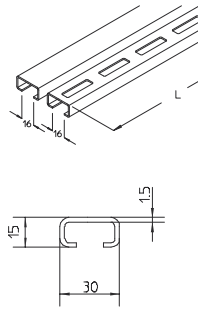

LGG 60

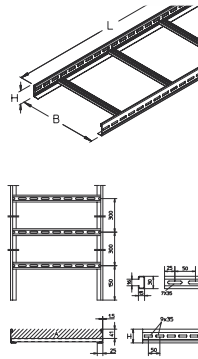

LGGS 60

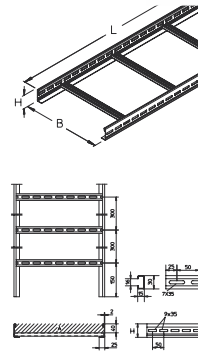

LGG 100

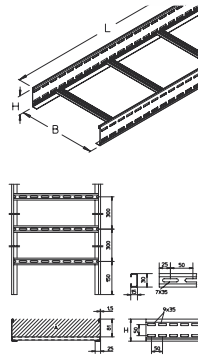

LGGS 100

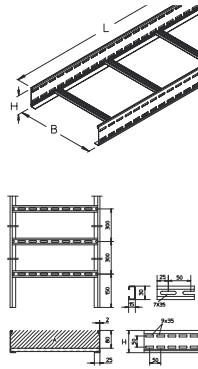

WPL 120

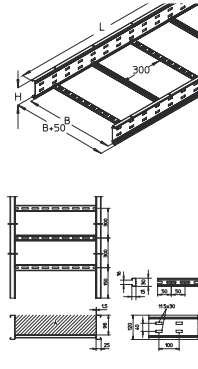

WPL 150

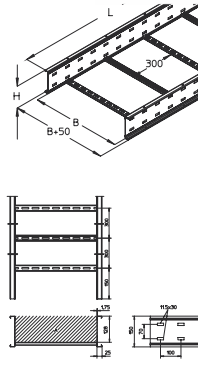

Uchwyty kablowe - zastosowanie

Informacje techniczne

B Montaż uchwyty B

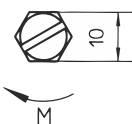
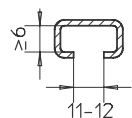
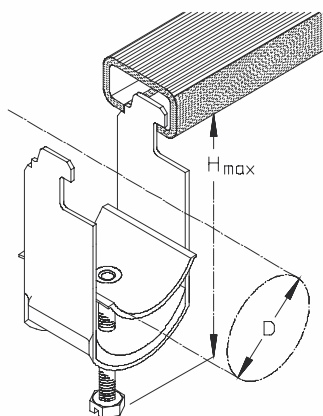

B 3

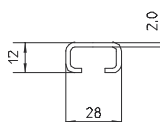
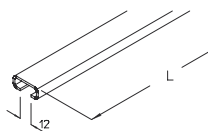

B 6

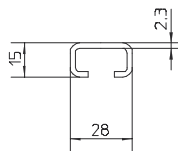
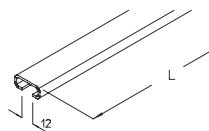

LG 50

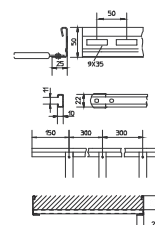
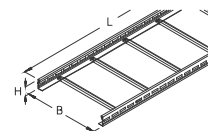

LG 60

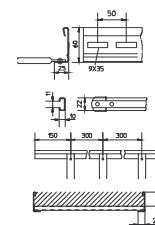
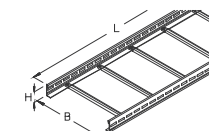

LGS 60

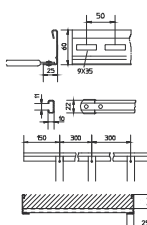
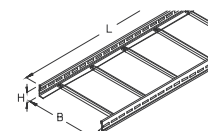

LG 100

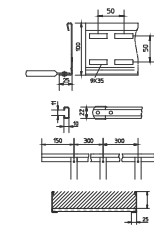
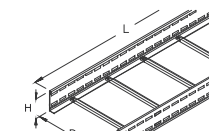

Uchwyty kablowe - zastosowanie

Informacje techniczne

HB Montaż uchwyty HB

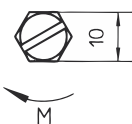
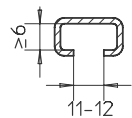
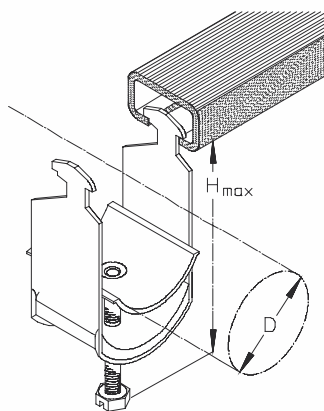

B 3

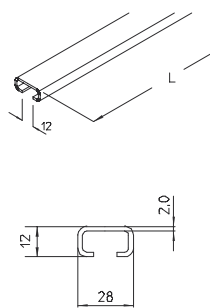

B 6

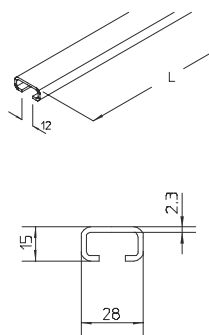

LG 50

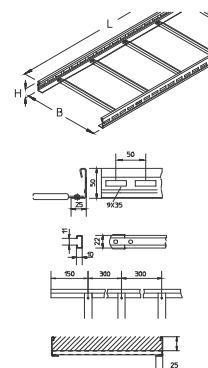

LG 60

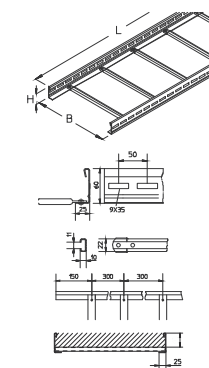

LGS 60

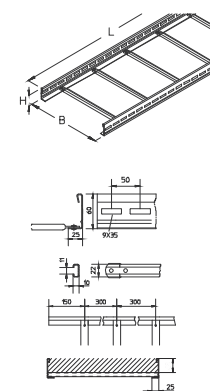

LG 100

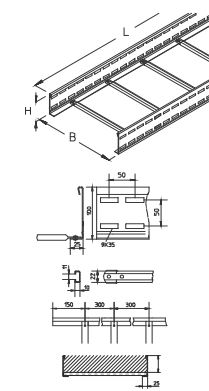

Uchwyty kablowe - zastosowanie

Informacje techniczne

HB-IW Montaż uchwyty HB-IW

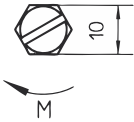
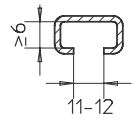
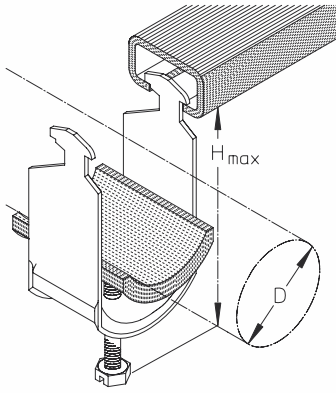

B 3

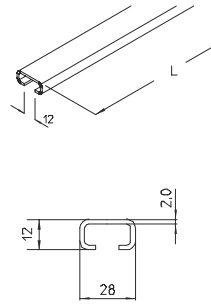

B 6

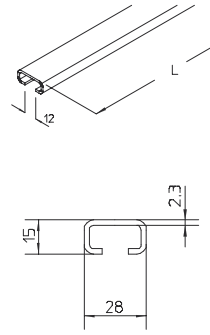

LG 50

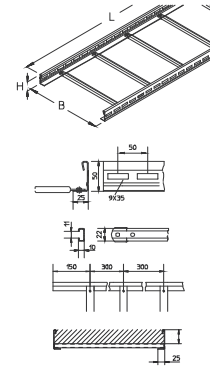

LG 60

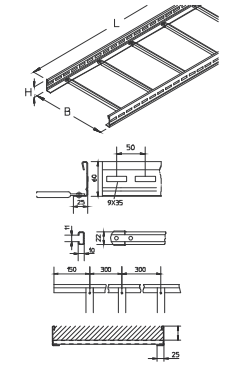

LGS 60

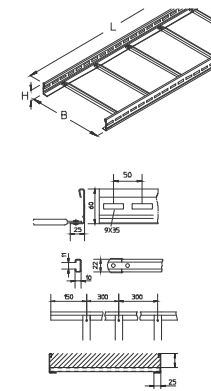

LG 100

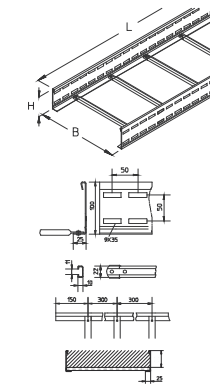

Uchwyty kablowe - zastosowanie

Informacje techniczne

ACF-E Montaż uchwyty ACF-E

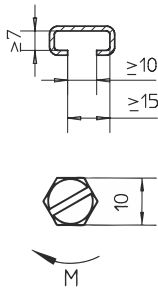
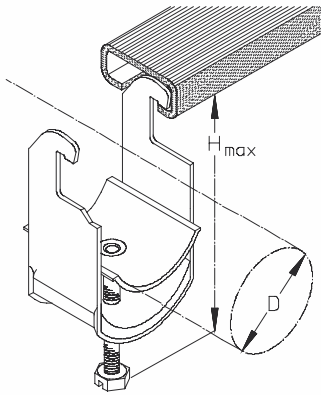

A 41 / KHA 41

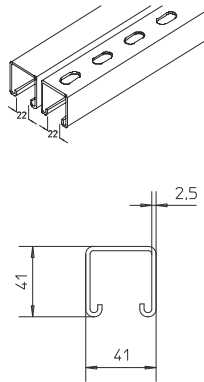

A 2 / KHA 2

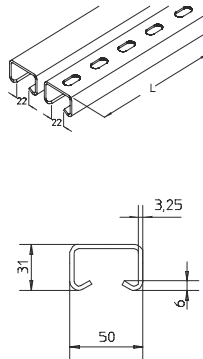

A 4 / KHA 4

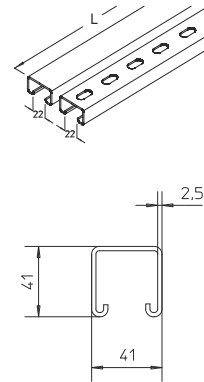

A 7 / KHA 7

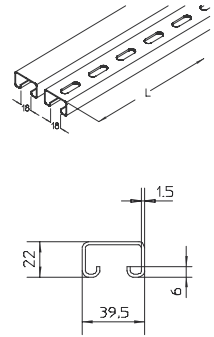

A 8 / KHA 8

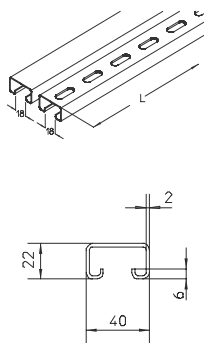

A 9 / KHA 9

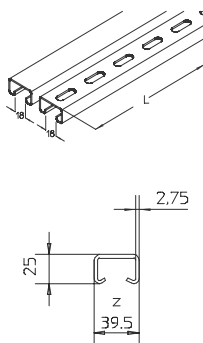

B3

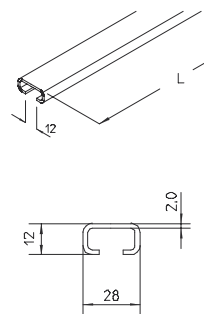

B 6

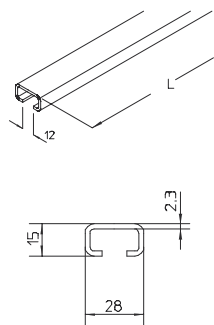

LG 50

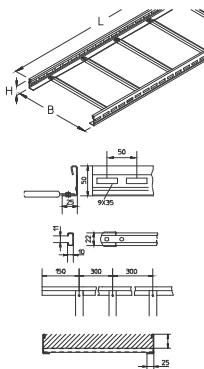

LG 60

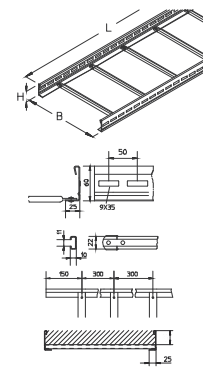

LGS 60

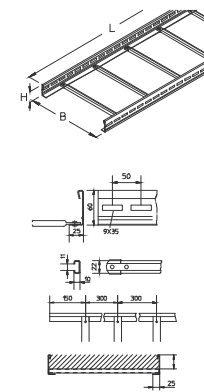

LG 100

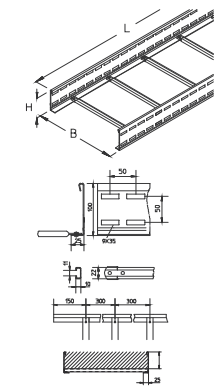

Uchwyty kablowe - zastosowanie

Informacje techniczne

S Montaż uchwyty S

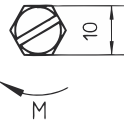
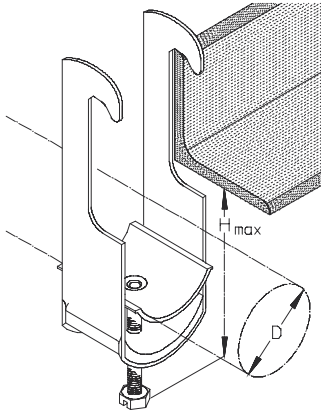

Rozmiar klucza SW 13
Średnica D ≥ 150

Kątownik

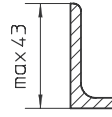

S-IW Montaż uchwyty S-IW

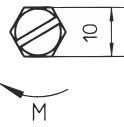
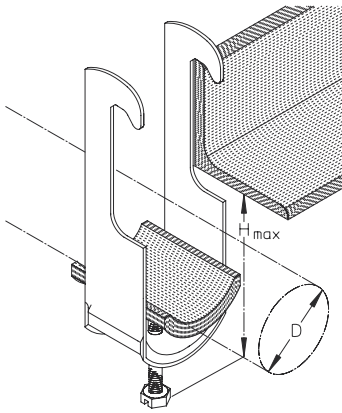

Rozmiar klucza SW 13
Średnica D ≥ 150

Kątownik

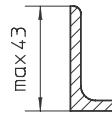

U Montaż uchwyty U

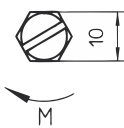
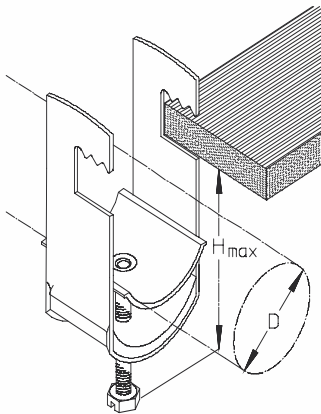

Rozmiar klucza SW 13
Średnica D ≥ 150

Płaskownik

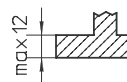

Uchwyty kablowe - zastosowanie

Informacje techniczne

U-IW Montaż uchwyty U-IW

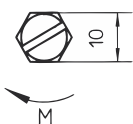
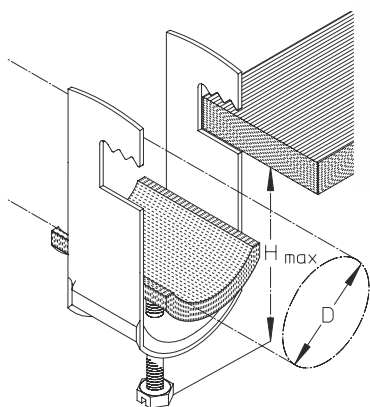

Rozmiar klucza SW 13
Średnica $D \geq 150$

Płaskownik

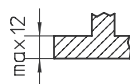

RU Montaż uchwyty RU

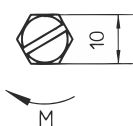
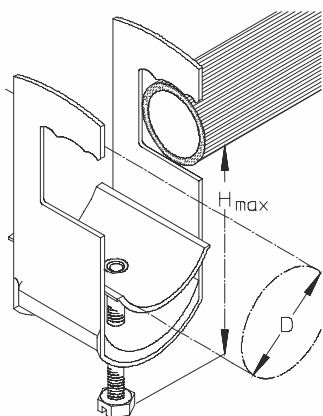

Rozmiar klucza SW 13

Płaskownik / rura

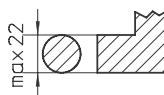

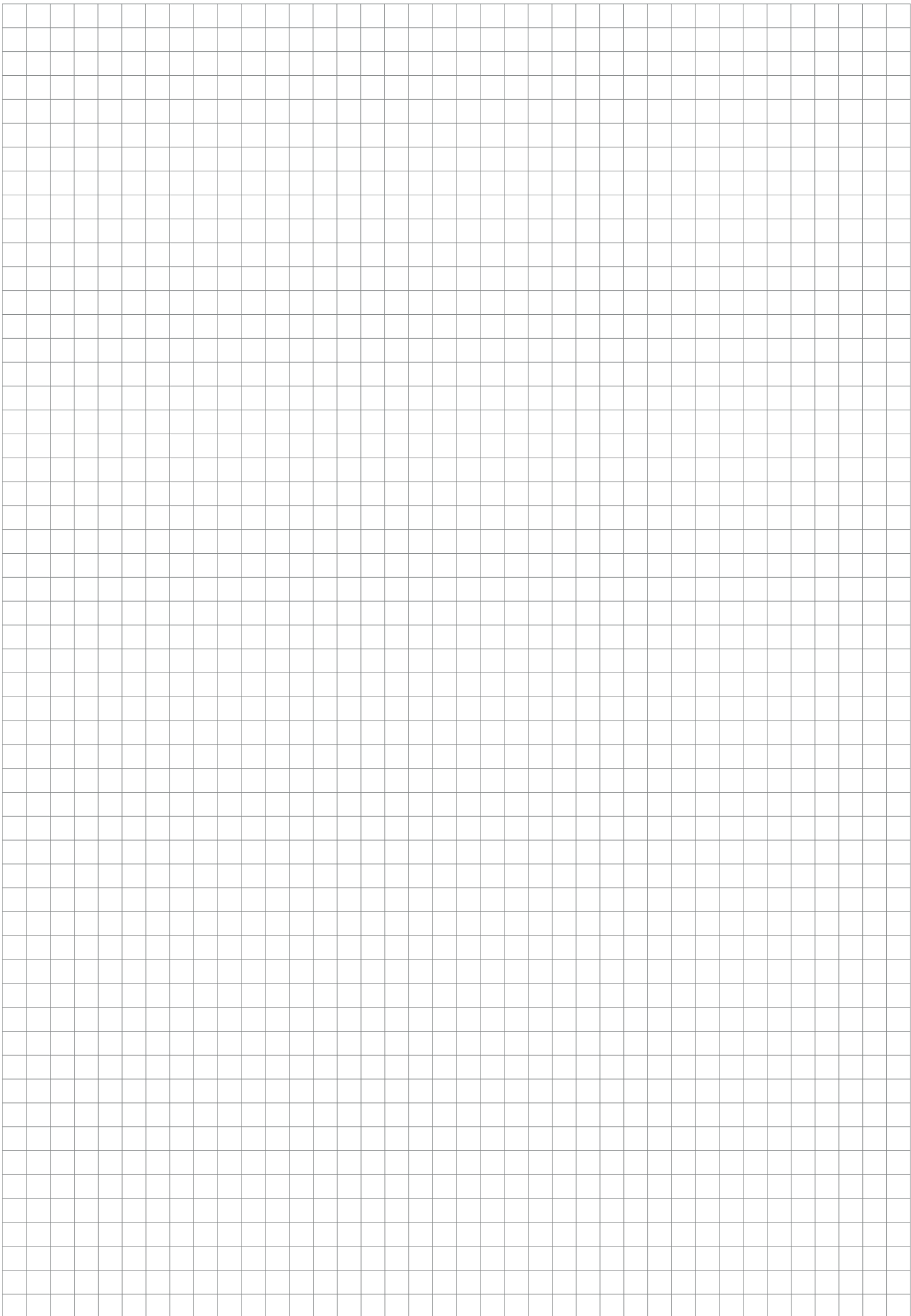



Błędy i zmiany techniczne zastrzeżone. Kopiowanie i jakiegokolwiek powielanie elektroniczne tylko za naszą pisemną zgodą. Wraz z publikacją tego dokumentu wszystkie poprzednie dokumenty tracą ważność.

